

# Wall oven and Zip heater typical installation and warranty requirements.



Instant Boiling Water



## 26.6 Installing two appliances on top of each other

Your appliance can also be installed above or below another appliance. Observe the installation dimensions and the installation instructions when installing appliances on top of each other.

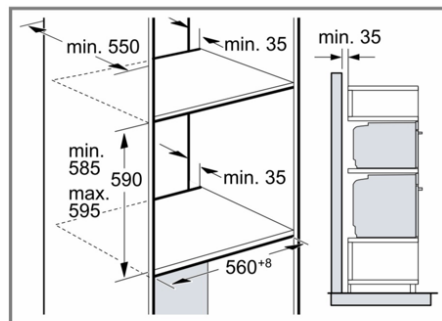

- To ventilate the appliances, the intermediate floor must have a ventilation cut-out.
- To ensure sufficient ventilation of the two appliances, there must be a ventilation opening of at least 200 cm<sup>2</sup> in the base area. To do this, trim the base panel or fit a ventilation grille.
- Ensure that air exchange is guaranteed in accordance with the diagram.

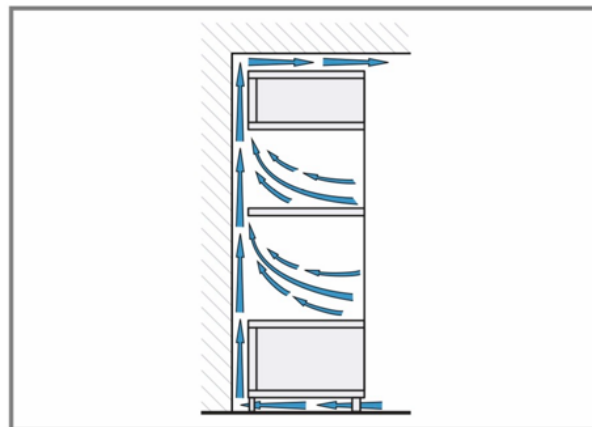

- Only fit appliances up to a height that allows accessories to be easily removed.

This warranty will not apply in the following cases:

4. The appliance is damaged as a direct result of incorrect installation or being used for a purpose for which it not designed, sold or otherwise not in accordance with any instructions for installation and use.

Many ovens are failing well before their time, due to overheating in a closed place. Even if there is a void and “chimney” up the back, the air doesn’t move out of the cavity. With pyrolytic ovens, it is even worse. There is also another problem that has been realised, that as HMR and MDF is heated, it gives off a Formaldehyde gas that has been evaluated by the International Agency for Research on Cancer (IARC) as group 1 carcinogenic to humans.

In a normal kitchen, formaldehyde gas is released in small quantities that “off gas” over about 2 years. However, when the board is heated, the gas is much more toxic and can have affect on humans.

I.C.V. Vents have a temperature operated fan that keeps the oven cavity at 40c, which is a little more than room temperature.

It can also be ducted outside to prevent any toxic gas or even just hot air from blowing back into the kitchen. If there is two ovens and a steam oven above, you can link three temp switches together and fitting one over each appliance, will turn the exhaust fan on when it heats up. The exhaust fan moves 1m<sup>3</sup> of air per minute, which is approximately three standard small bedrooms of air per hour.

As soon as the temperature goes below 40c the fan turns off.

There is also a smaller fan that is perfect for Zip hot water heaters, which are notorious for overheating. They move approximately .3m<sup>3</sup> per minute.

The fans can blow into an adjoining cupboard and an I.C.V. Front shelf vent can be fitted in that cupboard, allowing the air to exhaust out through the front of the bottom shelf.

It can also be directed into a fridge space, or in the case of the Zip heater fan, into the dishwasher space or through the front rail, using an I.C.V. Front rail vent that fits on the front rail and directs the air out above the door.

### Ventilation

When installing air flow ducts, the following tools will be required:

- Jigsaw and 12mm Drill
- Keyhole or Wall Board saw.

### 2.2 The following instructions are critical if there is insufficient cupboard air circulation.

If the air flow, using the silicon door buffers, is insufficient, it will be necessary to fit a standard HydroTap vent kit, which ensures heat dissipation through natural convection via installed vents.

For high use applications, where the cupboard space temperature is near 35°C, or higher, the inlet vent (See Item B below) and silicon buffers, need to be fitted. If the airflow is still insufficient to maintain normal operating temperatures then the door outlet vent (See item D below) will need to be fitted.

Alternatively a fan kit may be installed, using the AUX din plug of the right hand side of the appliance (Contact your local service centre for availability).

**Note:** The vent kit has to be installed in a way that allows air to be drawn in from the bottom of the cupboard and expelled through the top of the cupboard. Therefore placement of the outlet vent should be towards the top of the door or on the side of the cupboard.

### Airflow through the cupboard

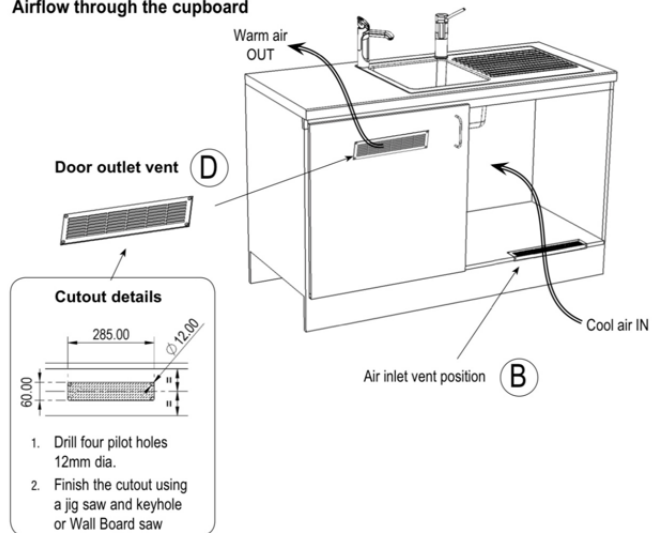

### Standard Warranty

a) the appliance is installed and used strictly in accordance with the instructions supplied